

1C9KX – Metric female swivel heavy series with O-ring

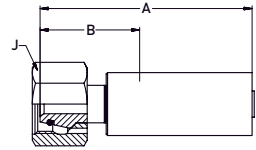

MATERIAL Carbon steel, zinc plated

| # | ⊙ | | | | ⌚ | A | B | J | ⌚ | |
|--------------|----|------|-----|------|---------|----|----|----|-----|--------|
| | DN | size | mm | inch | | mm | mm | mm | MPa | psi |
| 1C9KX-10-04W | 6 | -04 | 6.4 | 1/4 | M18x1.5 | 68 | 36 | 22 | 110 | 15,950 |
| 1C9KX-16-05W | 8 | -05 | 7.9 | 5/16 | M24x1.5 | 77 | 38 | 30 | 100 | 14,500 |

Fittings for water jetting applications

192KX – BSP female swivel (60° cone)

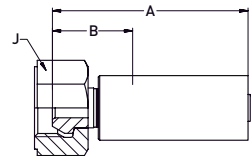

MATERIAL Carbon steel, zinc plated

| # | ⊙ | | | | ⌚ | A | B | J | ⌚ | |
|-------------|----|------|-----|------|-------|----|----|----|-----|--------|
| | DN | size | mm | inch | | mm | mm | mm | MPa | psi |
| 192KX-4-04W | 6 | -04 | 6.4 | 1/4 | G 1/4 | 56 | 25 | 19 | 110 | 15,950 |
| 192KX-6-05W | 8 | -05 | 7.9 | 5/16 | G 3/8 | 64 | 25 | 27 | 100 | 14,500 |

Fittings for water jetting applications

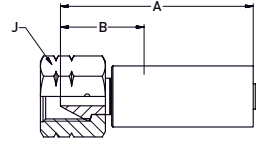

1AYKX – Type “M” female swivel**MATERIAL** Carbon steel, zinc plated

| # | ⊙ | | | | 🌀 | A | B | J | ↗ | |
|-------------|----|------|-----|------|--------------|----|----|----|-----|--------|
| | DN | size | mm | inch | | | | | MPa | psi |
| 1AYKX-6-04W | 6 | -04 | 6.4 | 1/4 | 9/16 - 18UNF | 61 | 30 | 22 | 110 | 15,950 |
| 1AYKX-8-05W | 8 | -05 | 7.9 | 5/16 | 3/4 - 16UNF | 70 | 31 | 27 | 100 | 14,500 |

Fittings for water jetting applications

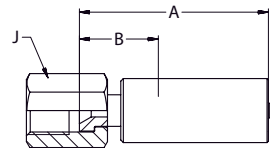
**65Y8X / 65YLX –
Medium pressure female swivel****MATERIAL** Carbon steel, zinc plated

| # | ⊙ | | | | 🌀 | A | B | J | ↗ | |
|------------|----|------|-----|------|-----------|----|----|----|-------|--------|
| | DN | size | mm | inch | | | | | MPa | psi |
| 65Y8X-6-4 | 6 | -04 | 6.4 | 1/4 | 9/16 - 18 | 71 | 39 | 19 | 112.0 | 16,240 |
| 65YLX-6-4C | 6 | -04 | 6.4 | 1/4 | 9/16 - 18 | 72 | 39 | 19 | 112.0 | 16,240 |

Fittings for hydraulic applications



1AY8X – Type “M” female swivel

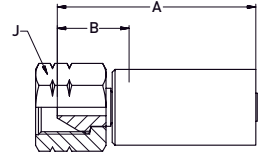

MATERIAL Carbon steel, zinc plated

| # | ⊙ | | | | ⌚ | A | B | J | ⌚ | |
|------------|----|------|-----|------|--------------|----|----|----|------|-------|
| | DN | size | mm | inch | | | | | MPa | psi |
| 1AY8X-8-05 | 8 | -05 | 7.9 | 5/16 | 3/4 - 16 UNF | 74 | 30 | 27 | 62.5 | 9,060 |
| 1AY8X-8-06 | 10 | -06 | 9.5 | 3/0 | 3/4 - 16 UNF | 70 | 26 | 27 | 57.5 | 8,340 |

Fittings for hydraulic applications

1018X / 601LX – National Pipe Tapered (NPT) male

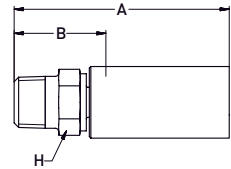

MATERIAL Carbon steel, zinc plated

| # | ⊙ | | | | ⌚ | A | B | H | ⌚ | |
|-------------|----|------|-----|------|--------------|----|----|----|------|--------|
| | DN | size | mm | inch | | | | | MPa | psi |
| 1018X-2-025 | 4 | -025 | 4 | 5/32 | 1/8 - 27NPTF | 51 | 24 | 8 | 75.0 | 10,890 |
| 1018X-4-025 | 4 | -025 | 4 | 5/32 | 1/4 - 18NPTF | 59 | 32 | 13 | 75.0 | 10,890 |
| 1018X-6-05 | 8 | -05 | 7.9 | 5/16 | 3/8 - 18NPTF | 70 | 30 | 19 | 93.8 | 13,600 |
| 601LX-4-5C | 8 | -05 | 7.9 | 5/16 | 1/4 NPT | 71 | 30 | 16 | 93.8 | 13,600 |
| 601LX-4-5 | 8 | -05 | 7.9 | 5/16 | 1/4 NPT | 71 | 30 | 16 | 93.8 | 13,600 |
| 601LX-6-5C | 8 | -05 | 7.9 | 5/16 | 3/8 NPT | 75 | 34 | 19 | 93.8 | 13,600 |
| 601LX-6-5 | 8 | -05 | 7.9 | 5/16 | 3/8 NPT | 75 | 34 | 19 | 93.8 | 13,600 |
| 1018X-6-06 | 10 | -06 | 9.5 | 3/0 | 3/8 - 18NPTF | 71 | 31 | 19 | 57.5 | 8,340 |
| 1018X-8-06 | 10 | -06 | 9.5 | 3/0 | 1/2 - 14NPTF | 76 | 36 | 22 | 57.5 | 8,340 |

Fittings for hydraulic applications



High pressure

1068X / 606LX – JIC female swivel

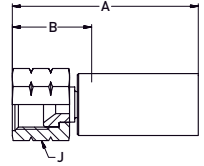
**MATERIAL** Carbon steel, zinc plated

| # | ⊙ | | | | 📐 | A | B | J | ↗ | |
|------------|----|------|-----|------|---------------|----|----|----|------|--------|
| | DN | size | mm | inch | | | | | MPa | psi |
| 606LX-8-5C | 8 | -05 | 7.9 | 5/16 | 3/4 - 16 UNF | 72 | 31 | 25 | 69.0 | 10,000 |
| 1068X-6-05 | 8 | -05 | 7.9 | 5/16 | 9/16 - 18 UNF | 56 | 16 | 19 | 62.5 | 9,060 |
| 1068X-8-05 | 8 | -05 | 7.9 | 5/16 | 3/4 - 16 UNF | 58 | 18 | 24 | 62.5 | 9,060 |

Fittings for hydraulic applications

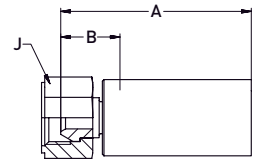
1928X / 192LX –
BSP female swivel (60° cone)**MATERIAL** Carbon steel, zinc plated

| # | ⊙ | | | | 📐 | A | B | J | ↗ | |
|-------------|----|------|------|------|-------|----|----|----|------|--------|
| | DN | size | mm | inch | | | | | MPa | psi |
| 1928X-4-025 | 4 | -025 | 4 | 5/32 | G 1/4 | 48 | 20 | 19 | 75.0 | 10,890 |
| 1928X-6-06 | 10 | -06 | 9.5 | 3/0 | G 3/8 | 59 | 19 | 22 | 57.5 | 8,340 |
| 1928X-8-06 | 10 | -06 | 9.5 | 3/0 | G 1/2 | 60 | 20 | 27 | 57.5 | 8,340 |
| 192LX-8-08 | 12 | -08 | 12.7 | 1/2 | G 1/2 | 75 | 21 | 32 | 57.5 | 8,340 |

Fittings for hydraulic applications



1D98X – BSP male

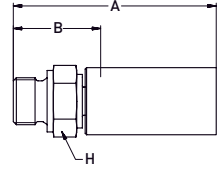

MATERIAL Carbon steel, zinc plated

| # | ⊙ | | | | ⌚ | A | B | H | ⌚ | |
|------------|----|------|-----|------|-------|----|----|----|------|-------|
| | DN | size | mm | inch | | | | | MPa | psi |
| 1D98X-6-05 | 8 | -05 | 7.9 | 5/16 | G 3/8 | 70 | 31 | 22 | 62.5 | 9,060 |

Fittings for hydraulic applications

1078X – NPSM female swivel

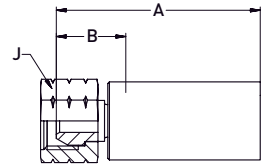

MATERIAL Carbon steel, zinc plated

NOTE C2W: Stainless steel nipple

| # | ⊙ | | | | ⌚ | A | B | J | ⌚ | |
|---------------|----|------|-----|------|--------------|----|----|----|------|-------|
| | DN | size | mm | inch | | | | | MPa | psi |
| 1078X-6-05 | 8 | -05 | 7.9 | 5/16 | 3/8 - 18NPSM | 60 | 21 | 22 | 62.5 | 9,060 |
| 1078X-6-06 | 10 | -06 | 9.5 | 3/0 | 3/8 - 18NPSM | 62 | 21 | 22 | 57.5 | 8,340 |
| 1078X-6-05C2W | 8 | -05 | 7.9 | 5/16 | 3/8 - 18NPSM | 60 | 21 | 22 | 62.5 | 9,060 |
| 1078X-6-06C2W | 10 | -06 | 9.5 | 3/0 | 3/8 - 18NPSM | 62 | 21 | 22 | 57.5 | 8,340 |

Fittings for hydraulic applications

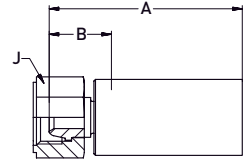

1U08X – BSP female swivel (ballnose)**MATERIAL** Carbon steel, zinc plated**NOTE** C2W: Stainless steel nipple

| # | ⊙ | | | | ⌚ | A | B | J | ↗ | |
|---------------|----|------|-----|------|-------|----|----|----|------|-------|
| | DN | size | mm | inch | | | | | MPa | psi |
| 1U08X-6-05 | 8 | -05 | 7.9 | 5/16 | G 3/8 | 59 | 19 | 19 | 67.5 | 9,790 |
| 1U08X-6-06 | 10 | -06 | 9.5 | 3/0 | G 3/8 | 61 | 20 | 22 | 52.5 | 7,610 |
| 1U08X-8-06 | 10 | -06 | 9.5 | 3/0 | G 1/2 | 61 | 20 | 27 | 52.5 | 7,610 |
| 1U08X-6-05C2W | 8 | -05 | 7.9 | 5/16 | G 3/8 | 59 | 19 | 19 | 67.5 | 9,790 |
| 1U08X-6-06C2W | 10 | -06 | 9.5 | 3/0 | G 3/8 | 61 | 20 | 22 | 52.5 | 7,610 |
| 1U08X-8-06C2W | 10 | -06 | 9.5 | 3/0 | G 1/2 | 61 | 20 | 27 | 52.5 | 7,610 |

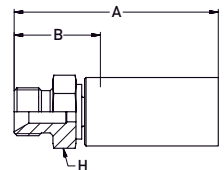
Fittings for hydraulic applications**13B8X / 13BNX – BSP male****MATERIAL** Carbon steel, zinc plated

| # | ⊙ | | | | ⌚ | A | B | H | ↗ | |
|-------------|----|------|------|-------|---------|-----|----|----|------|--------|
| | DN | size | mm | inch | | | | | MPa | psi |
| 13B8X-4-025 | 4 | -025 | 4 | 5/32 | G 1/4 | 57 | 30 | 17 | 75.0 | 10,880 |
| 13B8X-6-05 | 8 | -05 | 7.9 | 5/16 | G 3/8 | 69 | 30 | 22 | 62.5 | 9,060 |
| 13B8X-6-06 | 10 | -06 | 9.5 | 3/0 | G 3/8 | 70 | 30 | 22 | 57.5 | 8,340 |
| 13B8X-8-06 | 10 | -06 | 9.5 | 3/0 | G 1/2 | 75 | 35 | 22 | 57.5 | 8,340 |
| 13BNX-24-20 | 32 | -20 | 31.8 | 1 1/4 | G 1 1/2 | 118 | 57 | 55 | 27.5 | 3,990 |

Fittings for hydraulic applications

1C98X / 1C9LX / 1C9NX – Metric female swivel heavy series with O-ring

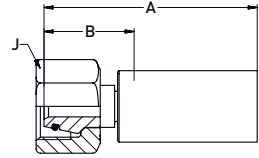

MATERIAL Carbon steel, zinc plated

| # | ⊙ | | | | ⌚ | A | B | J | ↻ | |
|-------------|----|------|------|-------|---------|-----|----|----|------|--------|
| | DN | size | mm | inch | | | | | MPa | psi |
| 1C98X-8-025 | 4 | -025 | 4 | 5/32 | M16x1.5 | 54 | 27 | 19 | 75.0 | 10,880 |
| 1C98X-12-06 | 10 | -06 | 9.5 | 3/0 | M20x1.5 | 70 | 30 | 24 | 62.5 | 9,060 |
| 1C98X-14-06 | 10 | -06 | 9.5 | 3/0 | M22x1.5 | 70 | 30 | 27 | 57.5 | 8,340 |
| 1C9LX-16-08 | 12 | -08 | 12.7 | 1/2 | M24x1.5 | 88 | 34 | 32 | 57.5 | 8,340 |
| 1C9NX-38-20 | 32 | -20 | 31.8 | 1 1/4 | M52x2 | 113 | 52 | 60 | 27.5 | 3,990 |

Fittings for hydraulic applications

1928X / 192LX – BSP female swivel (60° cone)

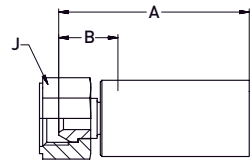

MATERIAL Carbon steel, zinc plated

| # | ⊙ | | | | ⌚ | A | B | J | ↻ | |
|-------------|----|------|------|------|-------|----|----|----|------|--------|
| | DN | size | mm | inch | | | | | MPa | psi |
| 1928X-4-025 | 4 | -025 | 4 | 5/32 | G 1/4 | 48 | 20 | 19 | 75.0 | 10,880 |
| 1928X-6-06 | 10 | -06 | 9.5 | 3/8 | G 3/8 | 59 | 19 | 22 | 57.5 | 8,340 |
| 1928X-8-06 | 10 | -06 | 9.5 | 3/8 | G 1/2 | 60 | 20 | 27 | 57.5 | 8,340 |
| 192LX-8-08 | 12 | -08 | 12.7 | 1/2 | G 1/2 | 75 | 21 | 32 | 55.0 | 7,980 |

Fittings for hydraulic applications

